

ALL PRODUCT DIMENSIONS ARE BEFORE COATING

## MATERIAL SPECIFICATION

LINER BODY (Part 1)

Ductile Iron to BS EN1563

Symbol EN-GJS-450-10

## CLAMP BANDS (Part 2)

Ductile Iron to BS EN1563

Symbol EN-GJS-450-10

## BOLTS (Part 3)

Stainless Steel to BS EN ISO3506-1

Grade A2 Property Class 70

## NUTS (Part 4)

Stainless Steel to BS EN ISO3506-2

Grade A4 Property Class 80

## WASHERS (Part 5)

Stainless Steel to BS EN ISO3506 -

Grade A2 Property Class 50

## O RING (Part 6)

As specified by order

## NOTES

Bolt Torque = 200-210Nm
-------------------------

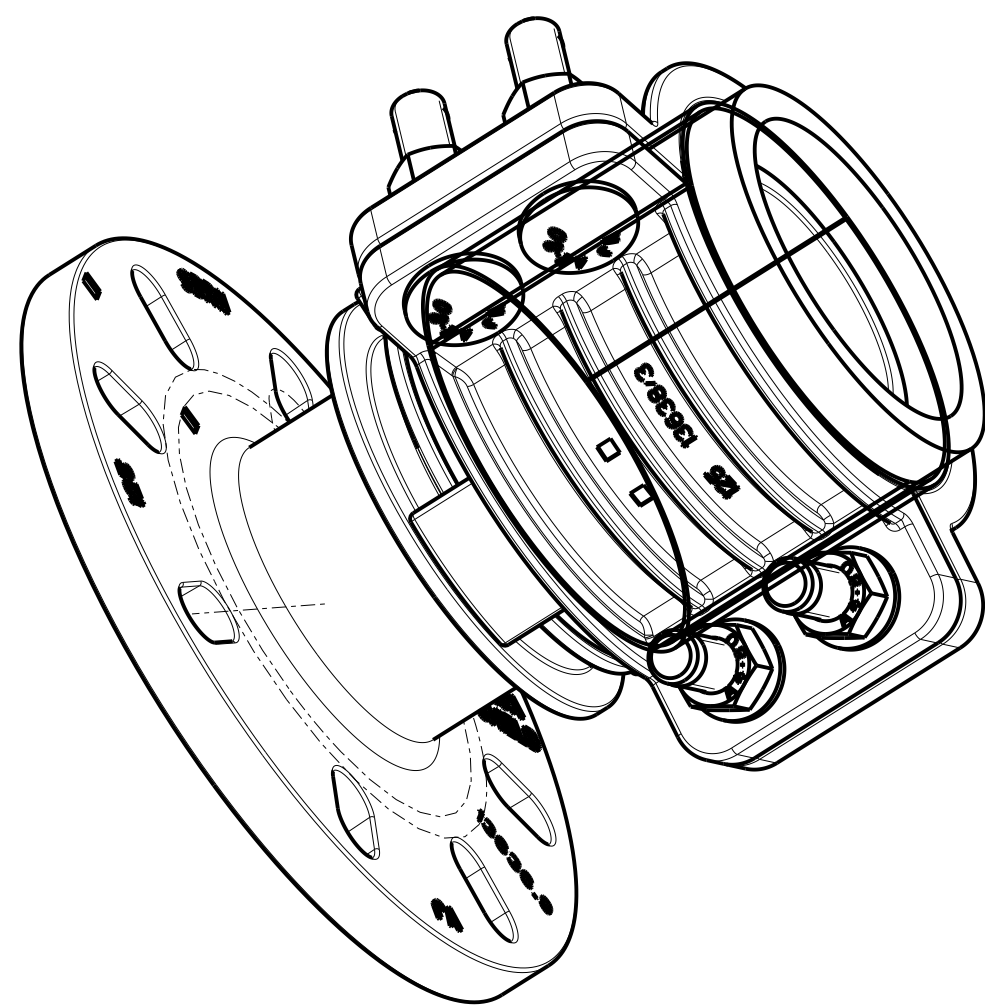

ISOMETRIC VIEW

REFERENCE DRAWING ONLY - NOT TO BE USED FOR INSPECTION PURPOSES.

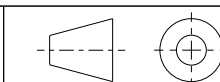

DO NOT SCALE

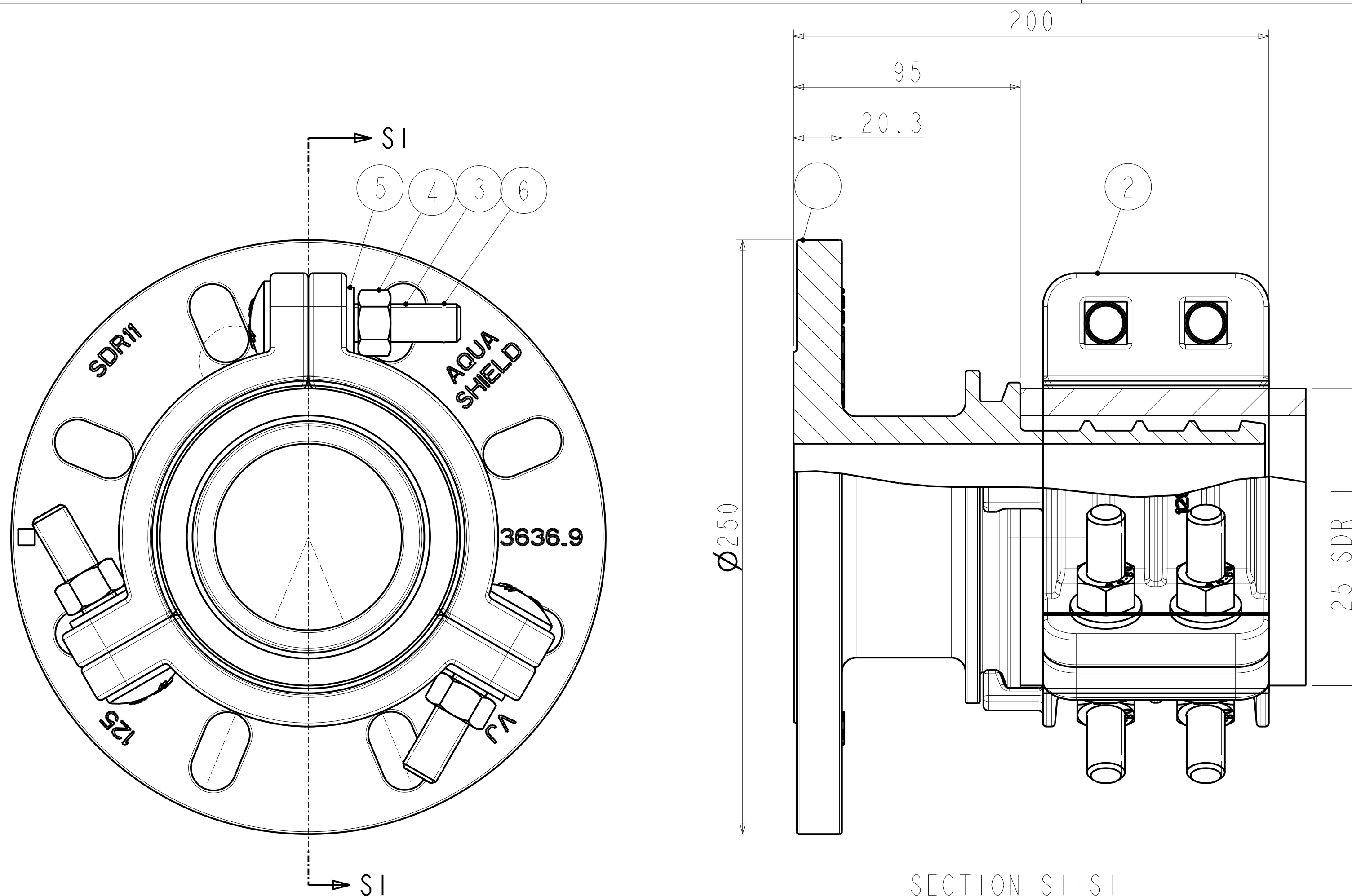

PIPE OD SDR RATING	FLANGE DRILLING	BOLT NO-DIAxLENGTH	WEIGHT Kg	ASSEMBLY DRG NO
125 SDR11		6-M16x80	16.1	13643_7

OVERALL DIMENSION DRAWING  
FOR REFERENCE ONLY  
VIKING JOHNSON RESERVE THE  
RIGHT TO AMEND DETAILS WITHOUT  
PRIOR NOTIFICATION

This drawing is the exclusive property of VIKING JOHNSON and is confidential and must not be reproduced or disclosed to a third party without written consent. It must be used only for the purpose which it has been issued and is returnable on request.

## OVERALL DIMENSIONS OF AQUASHIELD FLANGE ADAPTOR FOR 125 SDR11

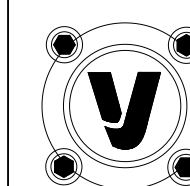

# VIKING JOHNSON

*World leaders in pipe joints and repair products*

DRAWN	AUTO	SCALE	1.000
DATE	May-04-23	GENERIC	O_DIM_13643_7

DRG NO 0\_DIM\_13643\_7\_2

**CRANE** A Crane Co Company

©

RF|FASF|FVFI: Released

SHEET 1 OF 1