

# ALL PRODUCT DIMENSIONS ARE BEFORE COATING

REFERENCE DRAWING ONLY - NOT TO BE USED FOR INSPECTION PURPOSES

DO NOT SCALE

## MATERIAL SPECIFICATION

**END RING (Part 1)**  
STEEL to  
BS EN10025-2:2004 GRADE S275JR  
**CENTRE SLEEVE (Part 2)**  
STEEL to  
BS EN10025-2:2004 GRADE S275JR  
**GASKET (Part 3)**  
RUBBER 80 HARDNESS  
Grade to suit service  
**BOLTS (Part 4)**  
STEEL BS EN ISO898-1:2009  
PROPERTY CLASS 4.8  
**NUTS (Part 5)**  
STEEL BS4190:2001  
GRADE 4  
**WASHERS (Part 6)**  
STAINLESS STEEL BS1449:PART 2:1983  
GRADE 304S15

## FINISH SPECIFICATION

## NOTES

Locating Plugs/Pin Register  
If Locating Plugs/Pins are required,  
3 are to be supplied.

## BOLT TORQUES

Torque to 95-120Nm or 70-90 lbf ft

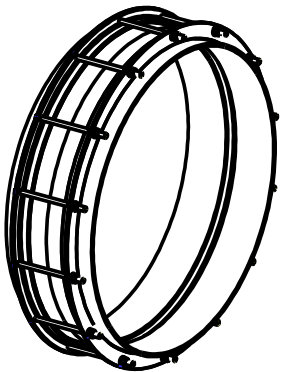

ISOMETRIC VIEW

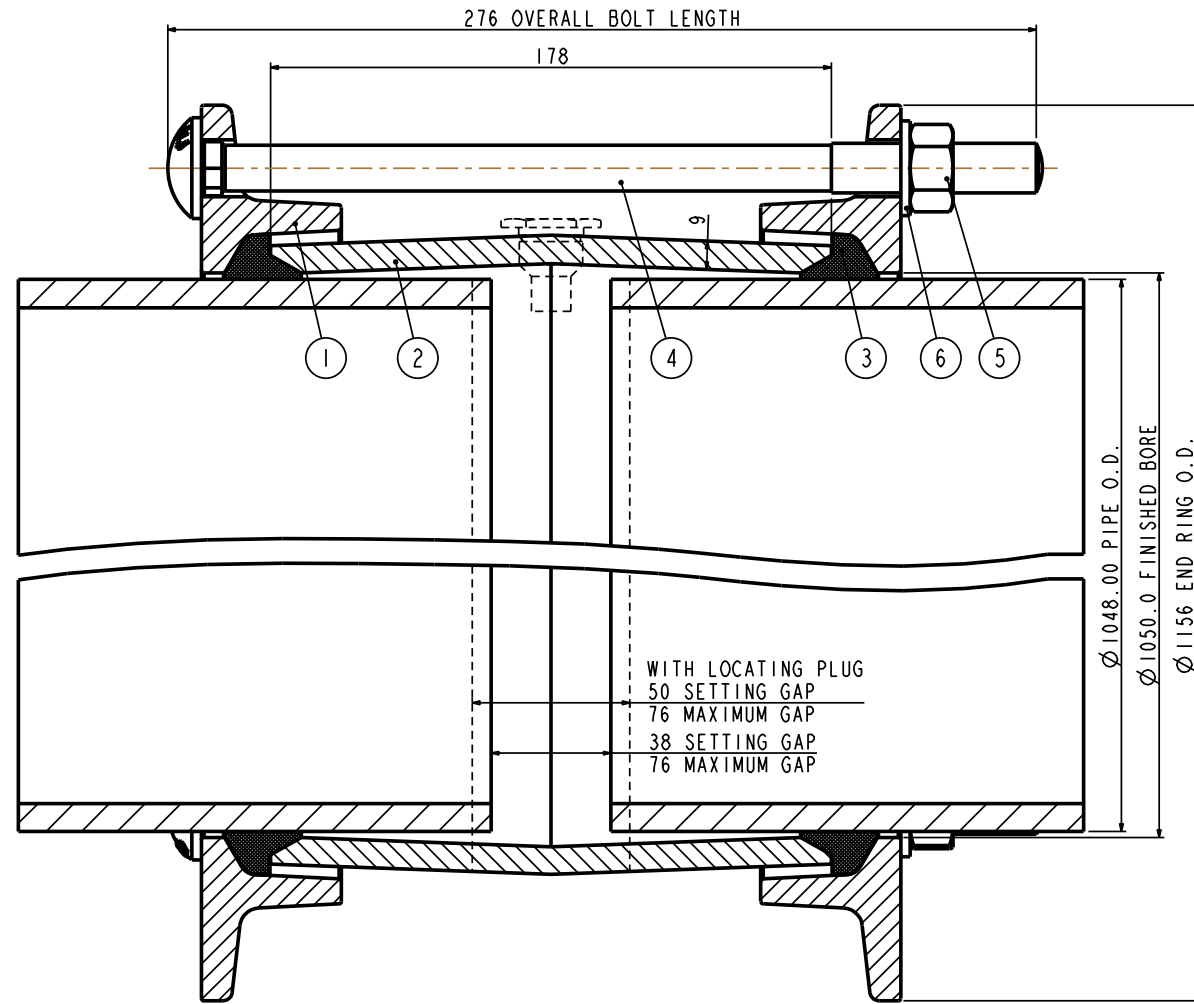

WITH LOCATING PLUG  
50 SETTING GAP  
76 MAXIMUM GAP  
38 SETTING GAP  
76 MAXIMUM GAP

PIPE O.D.	PIPE MATERIAL	PIPE TOLERANCE		BOLTS	GASKET MOULD	WORKING PRESSURE	TEST PRESSURE	WEIGHT KG	ASSEMBLY DRG NO
		+	-						
1048.00	DUCTILE IRON	1.00	5.00	14-M16x265	J71LS	18.4bar	27.7bar	96.90	7879_155

OVERALL DIMENSIONS DRAWING  
FOR REFERENCE ONLY  
VIKING JOHNSON RESERVE THE  
RIGHT TO AMEND DETAILS WITHOUT  
PRIOR NOTIFICATION

This drawing is the exclusive property of VIKING JOHNSON and  
is confidential and must not be reproduced or disclosed to a third  
party without written consent. It must be used only for the  
purpose which it has been issued and is returnable on request.

CRANE A Crane Co Company

OVERALL DIMENSIONS OF  
VIKING JOHNSON COUPLING ASSEMBLY  
'YF2' SECTION  
FOR 1048.00mm O.D. PIPE

RELEASE LEVEL: Manufacture

SHEET 1 OF 1



DRAWN	AUTO	SCALE	1:250
DATE	29/11/10	GENERIC	7879

DRG NO SKP40-1