

AquaFast Flange Adaptors

Specifications

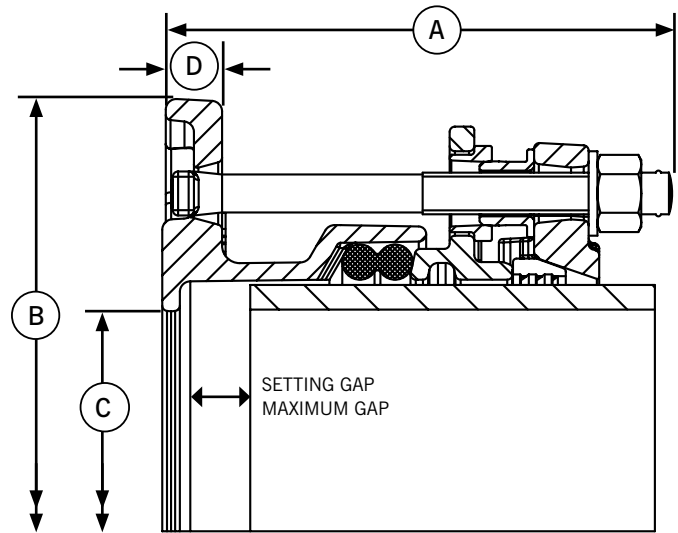

Flange Adaptor

| Pipe OD | Flange Drillings | Tee Bolt Size No.-Dia x Length | Dimensions (mm) | | Bore C (mm) | Flange Thickness D (mm) | Setting Gap (mm) | Max Gap (mm) | Weight (kg) |
|---------|------------------|--------------------------------|-----------------|-------|-------------|-------------------------|------------------|--------------|-------------|
| | | | A max | B dia | | | | | |
| 63 | 50/65 PN10,16 | 2-M12 x 135 | 144 | 185 | 50 | 17 | 20 | 25 | 4.4 |
| 75 | 65/80 PN10,16 | 2-M12 x 135 | 144 | 200 | 65 | 17 | 20 | 25 | 4.8 |
| 75 | 60 PN10,16 | 2-M12 x 135 | 144 | 200 | 65 | 17 | 20 | 25 | 4.9 |
| 90 | 65/80 PN10,16 | 2-M12 x 135 | 144 | 200 | 80 | 17 | 20 | 25 | 5.0 |
| 110 | 100 PN10,16 | 2-M12 x 135 | 144 | 229 | 100 | 17 | 20 | 25 | 6.1 |
| 125 | 100/125 PN10,16 | 2-M12 x 135 | 144 | 250 | 100 | 17 | 20 | 25 | 7.2 |
| 140 | 125 PN10,16 | 4-M12 x 135 | 144 | 250 | 125 | 17 | 20 | 25 | 7.4 |
| 160 | 150 PN10,16 | 4-M12 x 135 | 144 | 285 | 150 | 17 | 20 | 25 | 8.5 |
| 180 | 150 PN10,16 | 4-M12 x 190 | 199 | 285 | 150 | 17 | 25 | 35 | 12.4 |
| 200 | 200 PN10,16 | 4-M12 x 190 | 200 | 343 | 190 | 18 | 25 | 35 | 15.4 |
| 225 | 200 PN10,16 | 4-M16 x 195 | 205 | 343 | 190 | 18 | 25 | 35 | 16.9 |
| 250 | 250 PN10,16 | 6-M16 x 195 | 207 | 406 | 240 | 20 | 25 | 35 | 22.5 |
| 280 | 250 PN10,16 | 6-M16 x 195 | 207 | 406 | 270 | 20 | 25 | 35 | 22.1 |
| 315 | 300 PN10,16 | 6-M16 x 195 | 208 | 483 | 300 | 21.5 | 25 | 35 | 28.2 |

All flange drilled to BS EN 1092-1 (formerly BS 4504) /BS EN ISO 7005 PN10 and PN16

Materials & Relevant Standards

Centre Sleeve, End Ring and Flange Adaptor Body

Ductile iron to BS EN 1563 Symbol EN-GJS-450-10

Gripper Ring

Ductile iron to BS EN 1563 Symbol EN-GJS-450-10

Intermediate Ring

Ductile iron to BS EN 1563 Symbol EN-GJS-450-10

Bolts

BS EN ISO 898-1 Property class 8.8

Stainless Steel option - BS EN ISO3506-1 Grade A2

Property Class 70 (Stainless steel available as special order)

Nuts

Steel to BS EN20898-2 Grade 8

Stainless Steel option - BS EN ISO3506-2 Grade A4

Property Class 80 (Stainless steel available as special order)

Washers

BS 1449:Part 2 Grade 304S15

Gasket (EPDM)

BS EN 681-1 Type WA/BS 6920 hardness to 70 IRHD

Resisters

Free cutting Mild Steel (Grade Y15) Zn3 Zinc coated

Coatings

Centre sleeve, end ring, flange adaptor body and intermediate ring:

Rilsan Nylon 11

Gripper: Cathaphoretic coating

Bolts, nuts: Sheraplex to WIS 4-52-03

Pressure Rating

Working 16 bar

Test 24 bar

Approvals

All water contact materials approved for use with potable water by WRAS.

Every effort has been made to ensure that the information contained in this publication is accurate at the time of publishing. Crane Ltd assumes no responsibility or liability for typographical errors or omissions or for any misinterpretation of the information within the publication and reserves the right to change without notice.