

HANDICLAMP

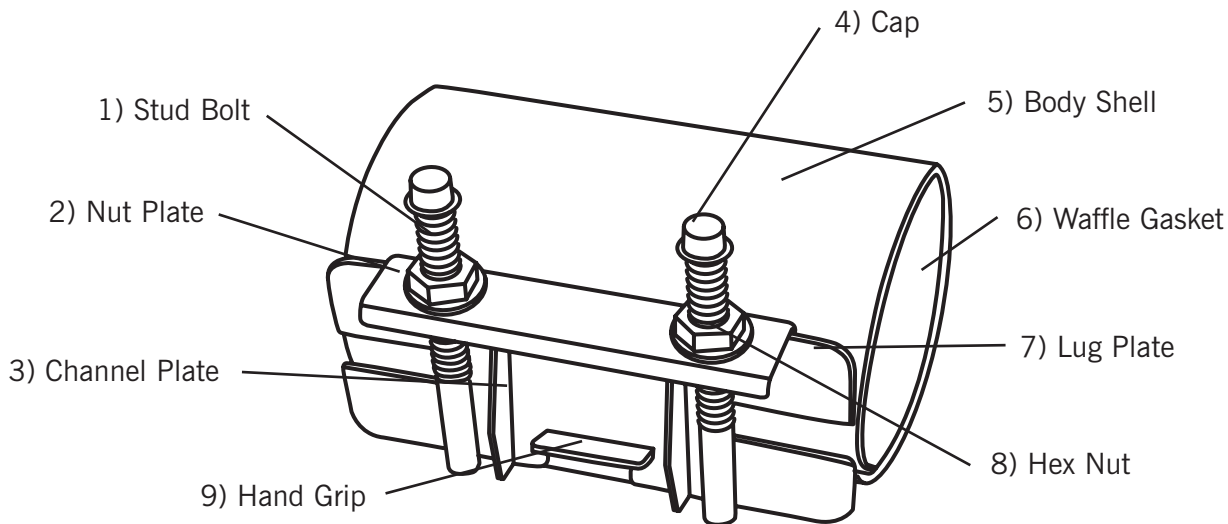

INSTALLATION OF SINGLE BAND REPAIR CLAMP

- 1) Check that the actual outside diameter of the damaged pipe falls within the range of the HandiClamp selected (Fig 1) + (Fig 2).
- 2) Clean the outside of the pipe, and:
 - i) Brush off any loose dirt.
 - ii) Ensure all exposed edges from the hole, crack or gouge in the pipe are flush with the pipe OD.
- 3) Unhook the nut-plate (2) and open the fitting (Fig 3).

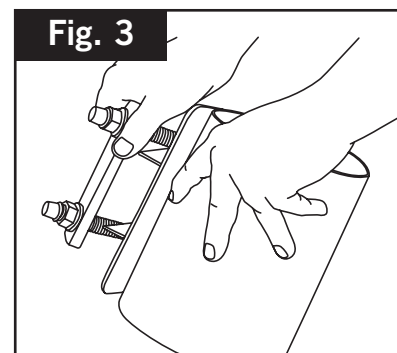
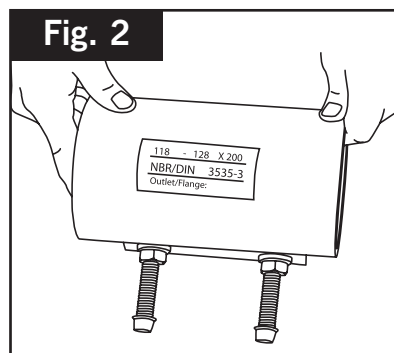
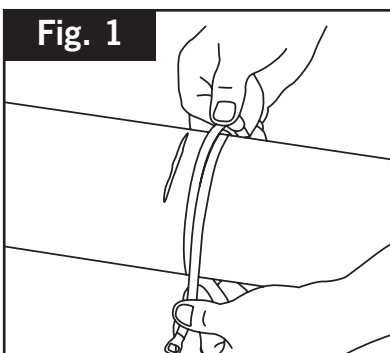

Please note: For use on PE pipe please contact Viking Johnson

VJ FI 1001

HANDICLAMP

INSTALLATION OF SINGLE BAND REPAIR CLAMP

- 4) Install the HandiClamp on the pipe some distance away from the damaged area:
 - i) Wrap HandiClamp around pipe (Fig 4).
 - ii) Close the clamp by pulling the hand-grip (9) towards the (opposite) lug-plate (7) and hooking the nut-plate over the lug-plate (Fig 5).
 - iii) Loosely tighten the hex nuts (8) to hold nut plate in position (Fig 6).

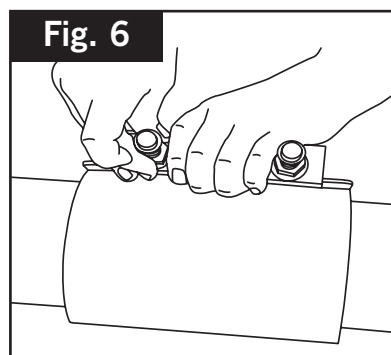
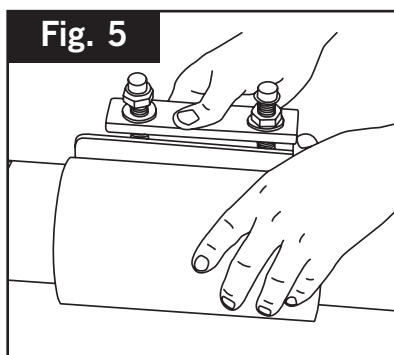
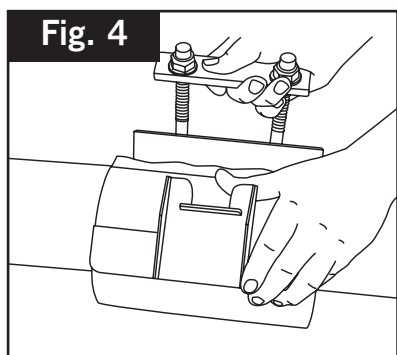

- 5) Install the HandiClamp over the damaged section of pipe: Slide the fitting over the damaged section of pipe ensuring that it is centralised over the damaged area (Fig 7).

Bolt Size	Torque Nm
M12	55-70
M14	70-85
M16	95-110

- 6) Tighten the nuts evenly to the recommended bolt torque (Fig 8) (see table).

- 7) Finally, check that correct bolt torque has been achieved (Fig 9).

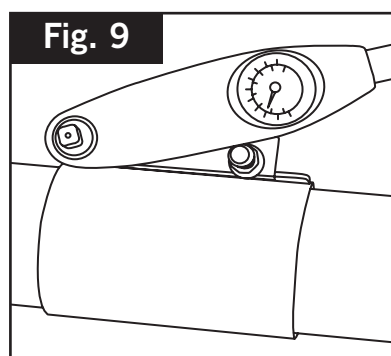
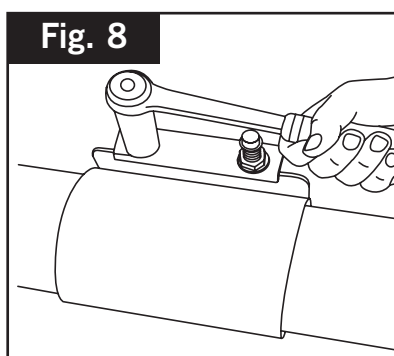
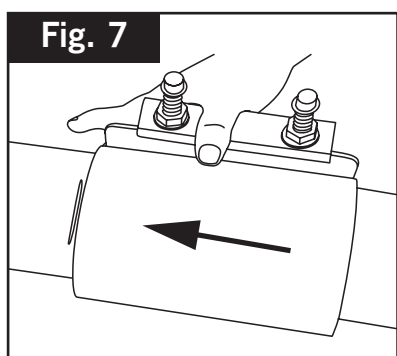

Please note: For use on PE pipe please contact Viking Johnson