



DISMANTLING JOINTS

Version: 02 - 01/05/2005

Dismantling Joints Technical Data Sheet

Dimensions

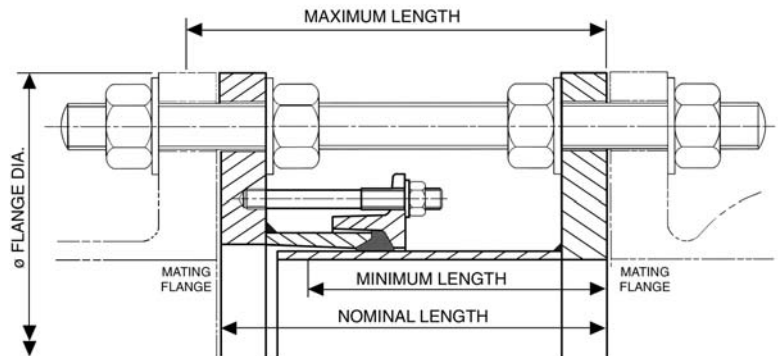

Nom	Spec*	Flange Dia mm	FLANGE TO FLANGE LENGTH			TIE ROD DETAILS USING THE FOLLOWING MATERIALS				Tie Rod Size Dia x Length
			Nominal mm	Minimum mm	Maximum mm	H.T Steel	Stainless Steel			
						BS4882 Grade MB7 or B7 Yield 725N/mm ² (No. off)	BS EN ISO 3506-1 Class 70 Yield 450N/mm ² (No. off)	BS970 Part 1 Grade 316S13 Yield 190N/mm ² (No. off)	BS970 Part 1 Grade 304S31 Yield 195N/mm ² (No. off)	
40	PN10,16,25,40	150	187	167	207	4	4	4	4	M16 x 300
50	PN10,16,25,40	185	187	167	207	4	4	4	4	M16 x 300
65	PN10,16	185	187	167	207	4	4	4	4	M16 x 300
80	PN10,16,25,40	210	187	167	207	4	4	4	4	M16 x 300
100	PN10,16	230	187	167	207	4	4	4	4	M16 x 300
100	PN25, 40	235	194	174	214	4	4	4	4	M20 x 340
125	PN10,16	285	187	167	207	4	4	4	4	M16 x 300
125	PN25, 40	270	194	174	214	4	4	4	4	M24 x 330
150	PN10,16	285	187	167	207	4	4	4	4	M20 x 310
150	PN25, 40	300	194	174	214	4	4	4	4	M24 x 330
175	PN10,16	315	187	167	207	4	4	4	4	M20 x 340
175	PN25	330	194	174	214	4	4	4	4	M24 x 350
175	PN40	350	194	174	214	4	4	4	4	M27 x 350
200	PN10	340	187	167	207	4	4	4	4	M20 x 310
200	PN16	340	187	167	207	4	4	4	4	M20 x 310
200	PN25	360	194	174	214	4	4	6	6	M24 x 355
200	PN40	375	194	174	214	4	4	6	6	M27 x 350
250	PN10	406	187	167	207	4	4	4	4	M20 x 310
250	PN16	405	187	167	207	4	4	6	4	M24 x 330
250	PN25	425	194	174	214	4	4	6	6	M27 x 350
250	PN40	450	194	174	214	4	4	12	12	M30 x 385
300	PN10	445	187	167	207	4	4	6	6	M20 x 310
300	PN16	460	187	167	207	4	4	6	6	M24 x 330
300	PN25	485	194	174	214	4	4	8	8	M27 x 350
300	PN40	515	194	174	214	4	4	16	16	M30 x 385
350	PN10	505	295	270	320	4	4	8	8	M20 x 440
350	PN16	520	295	270	320	4	4	8	8	M24 x 460
350	PN25	555	302	277	327	4	4	8	8	M30 x 500
350	PN40	580	307	277	337	4	4	16	16	M33 x 515
400	PN10	565	295	270	320	4	4	8	8	M24 x 460
400	PN16	580	295	270	320	4	4	8	8	M27 x 490
400	PN25	620	302	277	327	4	4	8	8	M33 x 515
400	PN40	660	307	277	337	4	8	16	16	M36 x 545

* Other flange drillings available



DISMANTLING JOINTS

Version: 02 - 01/05/2005

Dismantling Joints Technical Data Sheet

Dimensions

FLANGE DRILLING		Flange Dia mm	FLANGE TO FLANGE LENGTH			TIE ROD DETAILS USING THE FOLLOWING MATERIALS				Tie Rod Size Dia x Length
Nom	Spec*		Nominal mm	Minimum mm	Maximum mm	H.T Steel	Stainless Steel			
						BS4882 Grade MB7 or B7 Yield 725N/mm ² (No. off)	BS EN ISO 3506-1 Class 70 Yield 450N/mm ² (No. off)	BS970 Part 1 Grade 316S13 Yield 190N/mm ² (No. off)	BS970 Part 1 Grade 304S31 Yield 195N/mm ² (No. off)	
450	PN10	615	300	275	325	5	5	10	10	M24 x 460
450	PN16	640	300	275	325	5	5	10	10	M27 x 490
450	PN25	670	302	277	327	5	5	10	10	M36 x 570
450	PN40	685	307	277	337	5	10	20	20	1 1/8" x 19 1/2"
500	PN10	670	300	275	325	5	5	10	10	M24 x 460
500	PN16	715	300	275	325	5	5	10	10	M30 x 500
500	PN25	730	302	277	327	5	5	20	20	M33 x 515
500	PN40	755	307	277	337	5	10	20	20	M39 x 570
550	PN10	730	300	275	325	5	5	10	10	M27 x 490
550	PN16	775	300	275	325	5	5	20	20	M30 x 500
550	PN25	785	302	277	327	5	5	20	20	M36 x 545
550	PN40	835	320	290	350	5	5	20	20	M45 x 600
600	PN10	780	300	275	325	5	5	10	10	M27 x 490
600	PN16	840	300	275	325	5	5	10	10	M33 x 515
600	PN25	845	302	277	327	5	10	20	20	M36 x 545
600	PN40	890	320	290	350	5	10	20	20	M45 x 630
650	PN10	835	300	275	325	6	6	12	12	M27 x 490
650	PN16	860	300	275	325	6	6	24	24	M33 x 515
650	PN25	895	302	277	327	6	8	24	24	M36 x 545
650	PN40	945	320	290	350	6	6	24	24	M45 x 630
700	PN10	895	300	275	325	6	6	24	24	M27 x 490
700	PN16	910	300	275	325	6	6	24	24	M33 x 540
700	PN25	960	302	277	327	6	6	24	24	M39 x 570
700	PN40	995	320	290	350	6	12	24	24	M45 x 665
750	PN16	970	300	275	325	6	8	24	24	M33 x 540
800	PN10	1015	300	275	325	6	8	24	24	M30 x 500
800	PN16	1025	300	275	325	6	8	24	24	M36 x 545
800	PN25	1085	307	277	337	6	8	24	24	M45 x 630
800	PN40	1140	320	290	350	6	8	24	24	M52 x 680
900	PN10	1115	302	277	327	7	14	28	28	M30 x 530
900	PN16	1125	302	277	327	7	14	28	28	M36 x 570
900	PN25	1185	307	277	337	7	14	28	28	M45 x 630
900	PN40	1250	320	290	350	7	14	28	28	M52 x 725
1000	PN10	1230	307	277	337	7	14	28	28	M33 x 540
1000	PN16	1255	307	277	337	7	14	28	28	M39 x 600
1000	PN25	1320	320	290	350	7	14	28	28	M52 x 650
1000	PN40	1360	320	290	350	14	14	28	28	M52 x 755

* Other flange drillings available

Viking Johnson

46-48 Wilbury Way, Hitchin, Hertfordshire, SG4 0UD, United Kingdom
 Tel: +44 (0)1462 443322 Fax: +44 (0)1462 443311
 email: info@vikingjohnson.com www.vikingjohnson.com

CRANE

A Crane Co. Company



DISMANTLING JOINTS

Version: 02 - 01/05/2005

Dismantling Joints Technical Data Sheet

Dimensions

FLANGE DRILLING		Flange Dia mm	FLANGE TO FLANGE LENGTH			TIE ROD DETAILS USING THE FOLLOWING MATERIALS				Tie Rod Size Dia x Length
Nom	Spec*		Nominal mm	Minimum mm	Maximum mm	H.T Steel	Stainless Steel			
						BS4882 Grade MB7 or B7 Yield 725N/mm ² (No. off)	BS EN ISO 3506-1 Class 70 Yield 450N/mm ² (No. off)	BS970 Part 1 Grade 316S13 Yield 190N/mm ² (No. off)	BS970 Part 1 Grade 304S31 Yield 195N/mm ² (No. off)	
1100	PN10	1340	307	277	337	8	16	32	32	M33 x 540
1100	PN16	1355	307	277	337	8	16	32	32	M39 x 600
1200	PN10	1455	307	277	337	8	16	32	32	M36 x 570
1200	PN16	1485	320	290	350	8	16	32	32	M45 x 665
1200	PN25	1530	320	290	350	8	16	32	32	M52 x 725
1300	PN10	1575	320	290	350	8	16	32	32	M39 x 600
1300	PN16	1585	320	290	350	8	16	32	32	M45 x 665
1400	PN10	1675	320	290	350	9	12	36	36	M39 x 600
1400	PN16	1685	320	290	350	9	18	36	36	M45 x 665
1400	PN25	1755	462	412	512	9	18	36	36	M56 x 900
1500	PN10	1785	320	290	350	9	18	36	36	M39 x 640
1500	PN16	1820	320	290	350	9	12	36	36	M52 x 725
1600	PN10	1915	320	290	350	10	20	40	40	M45 x 630
1600	PN16	1930	320	290	350	10	20	40	40	M52 x 725
1600	PN25	1975	462	412	512	20	20	40	40	M56 x 960
1600	PN40	1025	462	412	512	20	40			M64 x 975
1800	PN10	2115	320	290	350	11	22	44	44	M45 x 630
1800	PN16	2130	320	290	350	11	22	44	44	M52 x 755
1800	PN25	2185	462	412	512	11	22	44	44	M64 x 1000
2000	PN10	2325	440	390	490	12	24	48	48	M45 x 795
2000	PN16	2345	462	412	512	12	24	48	48	M56 x 960
2200	PN10	2550	462	412	512	13	26	52	52	M52 x 900
2200	PN16	2555	462	412	512	13	26	52	52	M56 x 960
2400	PN10	2760	462	412	512	14	28	56	56	M52 x 900

* Other flange drillings available

Material Specification and Standards

Spigot Piece

Steel to BS EN10025:1993 Grade S275

Spigot

Up to and including 165.1mm - BS1387:1990

Over 165.1mm BS3601:1993

Flange Adaptor (up to DN300)

BS EN1563:1997 Grade EN-GJS-450-10

Flange Adaptor (above DN300)

Steel to BS EN10025:1993 Grade S275

Tie Rods

See table. Tie rods in highlighted columns are standard Viking Johnson supply.

Gaskets

EPDM Compound Grade 'E' to BS EN681:1996: Type W&D, WBS listed.

Coating:

Flange adaptor and flange spigot -

Rilsan Nylon 11 (Black) HT steel tie rods - Zn3 zinc coated

Dismantling Joints are designed and manufactured under Quality Management Systems certified to BS EN ISO 9001:2000 and the requirements of ISO 14001. Viking Johnson operates a policy of continual product improvement and innovation, and reserves the right to modify details in this publication. Information is correct at time of publishing. Additional dimensional information is available from our Marketing Department.

Viking Johnson

46-48 Wilbury Way, Hitchin, Hertfordshire, SG4 0UD, United Kingdom

Tel: +44 (0)1462 443322 Fax: +44 (0)1462 443311

email: info@vikingjohnson.com www.vikingjohnson.com

CRANE

A Crane Co. Company